

West Area Planning Committee Presentation

- 17/02495/RES
- 71 Westgate Centre

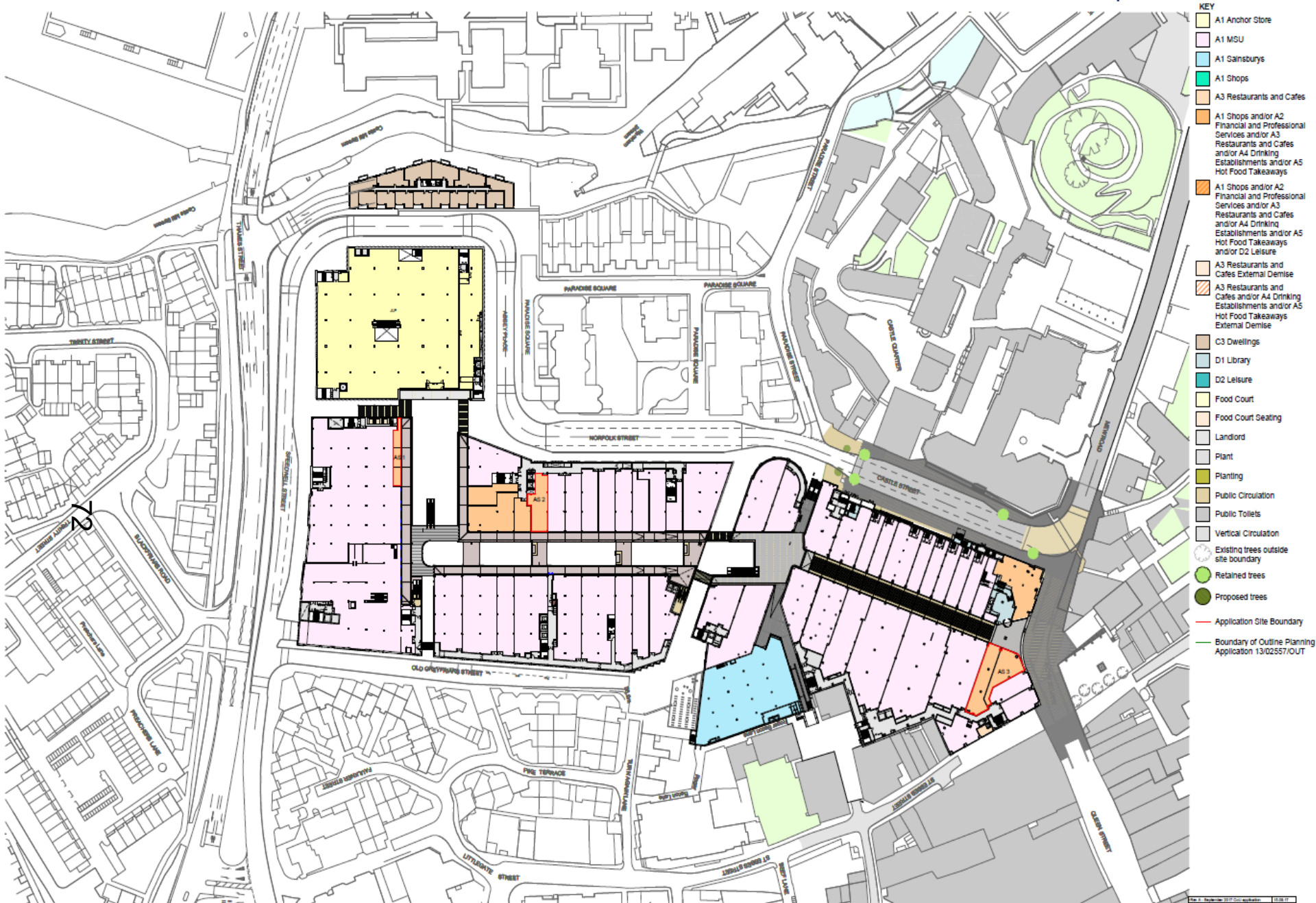

- KEY**
- A1 Anchor Store
 - A1 MSU
 - A1 Sainsburys
 - A1 Shops
 - A3 Restaurants and Cafes
 - A1 Shops and/or A2 Financial and Professional Services and/or A3 Restaurants and Cafes and/or A4 Drinking Establishments and/or A5 Hot Food Takeaways
 - A1 Shops and/or A2 Financial and Professional Services and/or A3 Restaurants and Cafes and/or A4 Drinking Establishments and/or A5 Hot Food Takeaways and/or D2 Leisure
 - A3 Restaurants and Cafes External Demise
 - A3 Restaurants and Cafes and/or A4 Drinking Establishments and/or A5 Hot Food Takeaways External Demise
 - C3 Dwellings
 - D1 Library
 - D2 Leisure
 - Food Court
 - Food Court Seating
 - Landlord
 - Plant
 - Planting
 - Public Circulation
 - Public Toilets
 - Vertical Circulation
 - Existing trees outside site boundary
 - Retained trees
 - Proposed trees
 - Application Site Boundary
 - Boundary of Outline Planning Application 13/02557/OUT

NOTE:
BCP has made revisions to this drawing (previously approved under reserved matters application 14/02420/01) on 5 December 2016 in respect of the units outlined in red. For ease of reference the drawing number remains the same except for the addition of '001'.

Upper Ground Floor Plan

Westgate Alliance

LandSecurities

THE CROWN ESTATE

BDP.

B. Planning Control Application		Scale
WESTGATE, CHORPD		
RESERVED MATTERS		
MASTERPLAN UPPER GROUND FLOOR PLAN	1:500	6/1
CHANGE OF USE (40-700m)	25.01.17	
BCP_18100_P01_CAL_BUI_001	A	

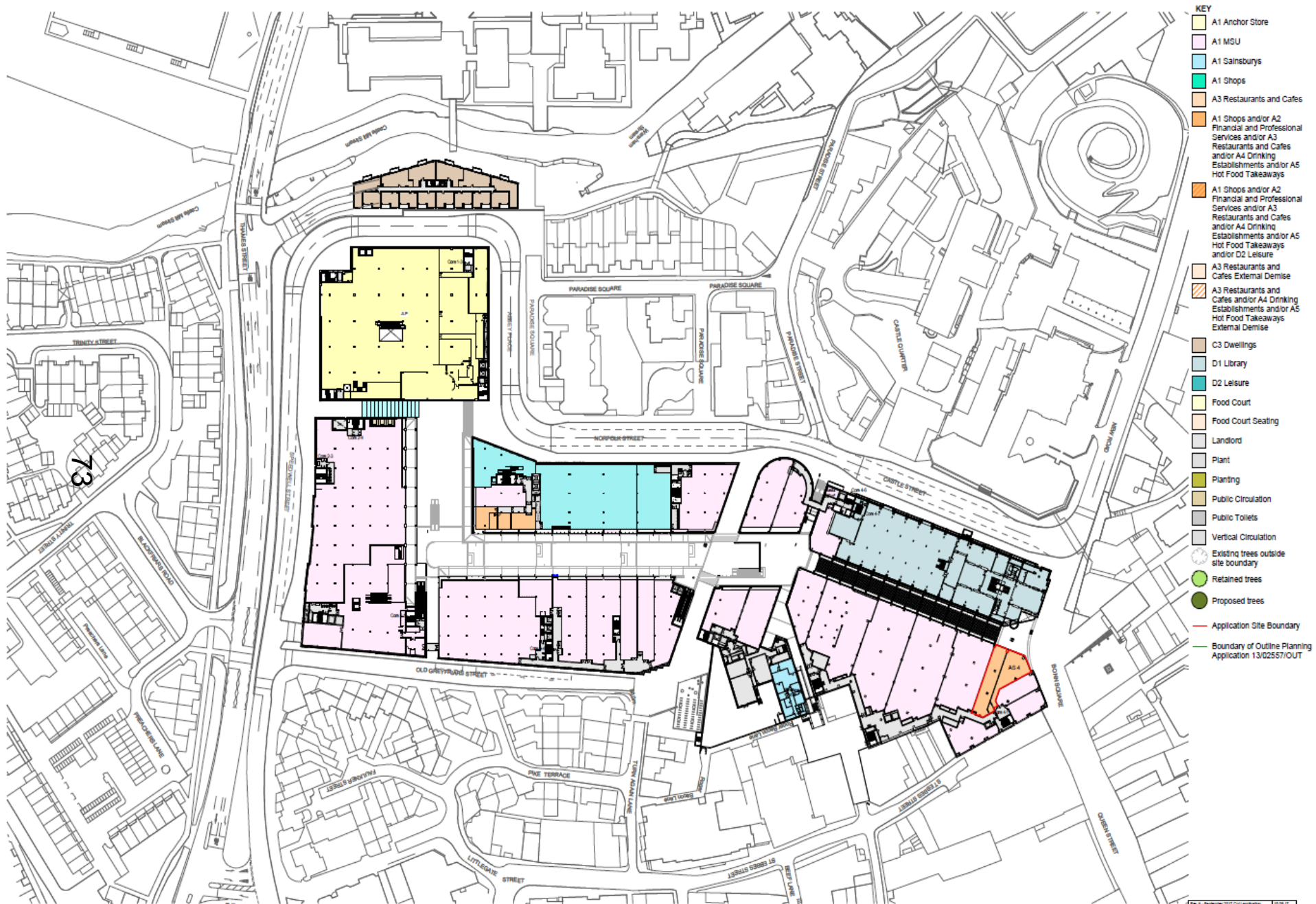

- KEY**
- A1 Anchor Store
 - A1 MSU
 - A1 Sainsburys
 - A1 Shops
 - A3 Restaurants and Cafes
 - A1 Shops and/or A2 Financial and Professional Services and/or A3 Restaurants and Cafes and/or A4 Drinking Establishments and/or A5 Hot Food Takeaways
 - A1 Shops and/or A2 Financial and Professional Services and/or A3 Restaurants and Cafes and/or A4 Drinking Establishments and/or A5 Hot Food Takeaways and/or D2 Leisure
 - A3 Restaurants and Cafes External Demise
 - A3 Restaurants and Cafes and/or A4 Drinking Establishments and/or A5 Hot Food Takeaways External Demise
 - C3 Dwellings
 - D1 Library
 - D2 Leisure
 - Food Court
 - Food Court Seating
 - Landlord
 - Plant
 - Planting
 - Public Circulation
 - Public Toilets
 - Vertical Circulation
 - Existing trees outside site boundary
 - Retained trees
 - Proposed trees
 - Application Site Boundary
 - Boundary of Outline Planning Application 13/02557/0/UT

NOTE
BDP has made reference to this drawing (previously approved under reserved matters application 14/04242/RES) on 5 December 2014 in respect of the units outlined in red. For ease of reference the drawing number remains the same except for the addition of 'OUT'.

First Floor Plan

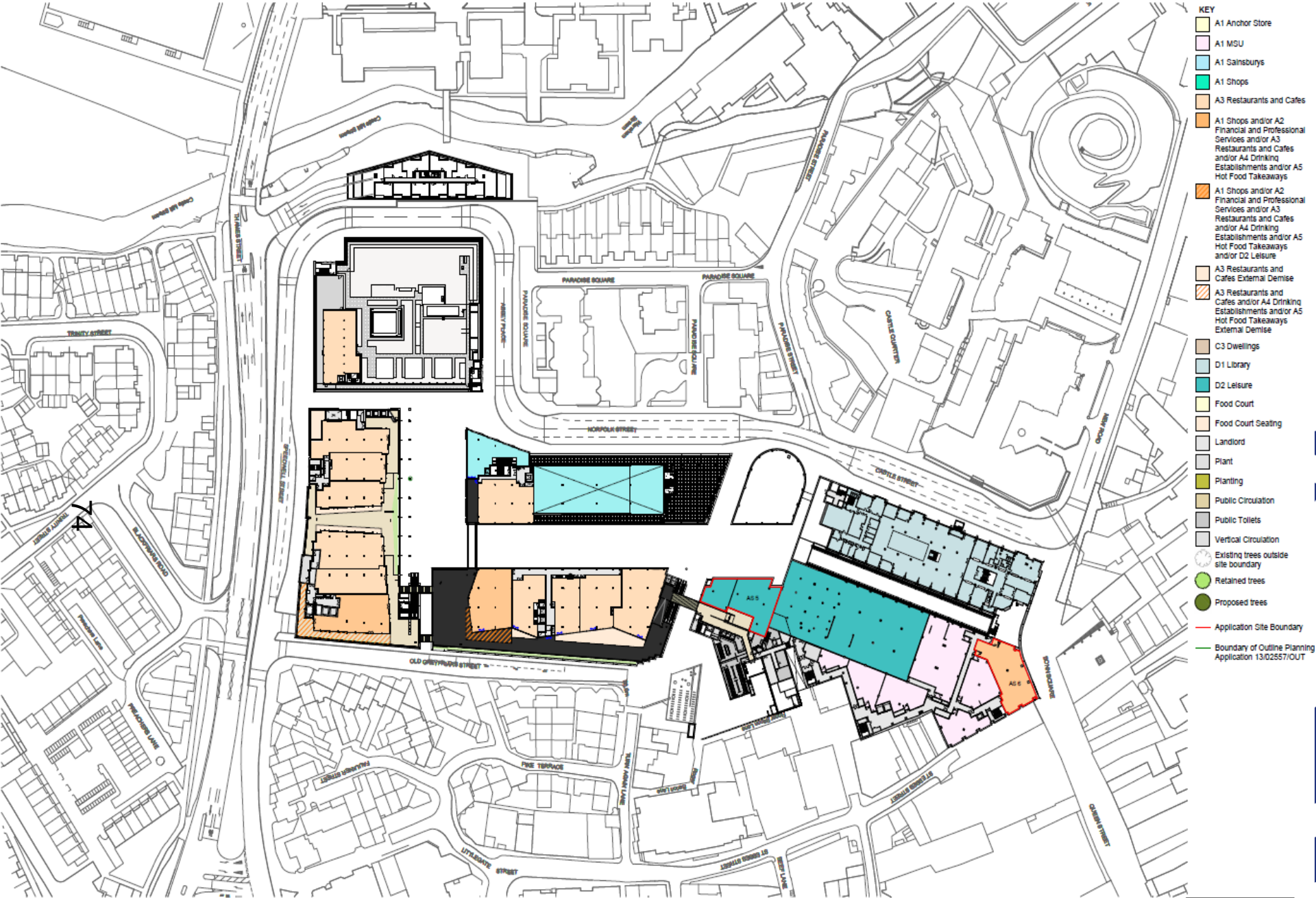

- KEY**
- A1 Anchor Store
 - A1 MSU
 - A1 Gainsburys
 - A1 Shops
 - A3 Restaurants and Cafes
 - A1 Shops and/or A2 Financial and Professional Services and/or A3 Restaurants and Cafes and/or A4 Drinking Establishments and/or A5 Hot Food Takeaways
 - A1 Shops and/or A2 Financial and Professional Services and/or A3 Restaurants and Cafes and/or A4 Drinking Establishments and/or A5 Hot Food Takeaways and/or D2 Leisure
 - A3 Restaurants and Cafes External Demise
 - A3 Restaurants and Cafes and/or A4 Drinking Establishments and/or A5 Hot Food Takeaways External Demise
 - C3 Dwellings
 - D1 Library
 - D2 Leisure
 - Food Court
 - Food Court Seating
 - Landlord
 - Plant
 - Planting
 - Public Circulation
 - Public Toilets
 - Vertical Circulation
 - Existing trees outside site boundary
 - Retained trees
 - Proposed trees
 - Application Site Boundary
 - Boundary of Outline Planning Application 13/02557/OUT

NOTE
BDP has made revisions to the drawing (previously approved under reserved matters application 14/02429/RES on 5 December 2014) in respect of the units outlined in red. For ease of reference the drawing number remains the same except for the addition of '02'.

Second Floor Plan

Site: Westgate 2017 Cont application 13/0257	
WESTGATE, OXFORD	
RESERVED MATTERS	
WATERPLAN SECOND FLOOR	8/11
PLAN	1:500
CHARGE OF USE (+1700)	25.01.17
BDP_MP1021_RM_COU_BN_02	A